

Lanhill Road, Maida Vale, London, W9

£565,000

Subject to contract

A beautifully designed, two bedroom apartment set on the second floor of this well maintained period residence. The apartment offers well-proportioned accommodation featuring a fantastic open plan kitchen/living room principal bedroom with fitted wardrobes, second good sized bedroom and family bathroom. Lanhill Road is a lovely residential area, moments from the amenities and transport links of Westbourne Park and Maida Vale. Paddington Recreation Ground is also within walking distance.

- Two Bedroom Apartment
- Second Floor
- Beautifully Designed
- Open Plan Kitchen/living room
- Superb Location
- Leasehold





Lanhill Road, W9

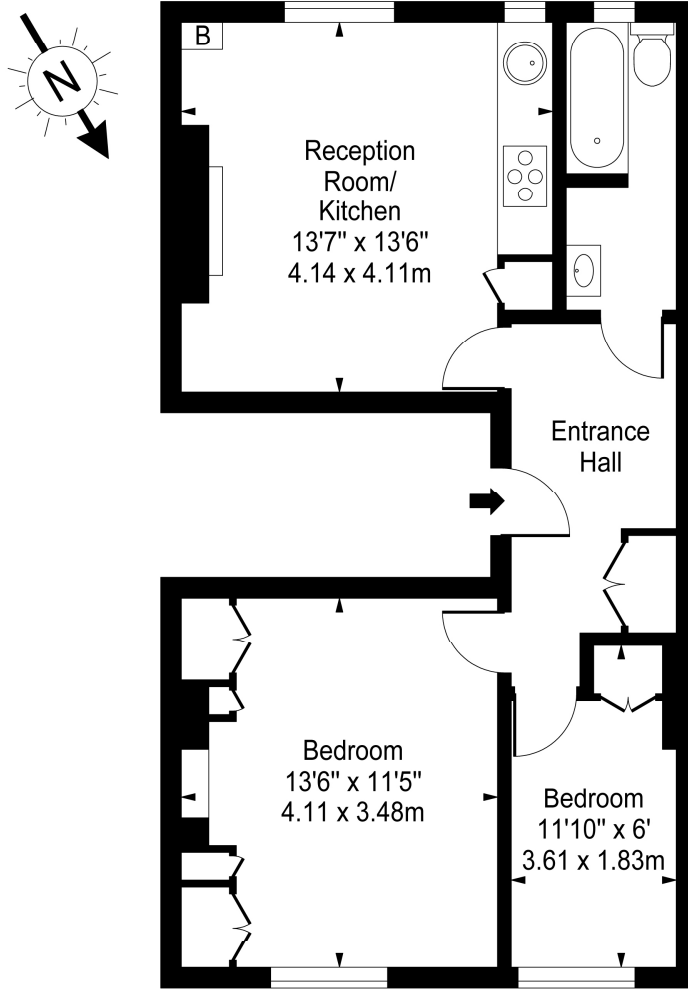

Second Floor

Approx Gross Internal Area **532 Sq Ft - 49.42 Sq M**

For Illustration Purposes Only - Not To Scale

www.goldlens.co.uk

Ref. No. 009984.1J

Agents Note: Whilst every care has been taken to prepare these sales particulars, they are for guidance purposes only. All measurements are approximate are for general guidance purposes only and whilst every care has been taken to ensure their accuracy, they should not be relied upon and potential buyers are advised to recheck the measurements