

Salisbury Road, Brondesbury Park, London, NW6

£540 per week + fees
Subject to contract

Set within this BRAND NEW build development is this fabulous two bedroom apartment situated on the third floor (with a lift) of this immaculately presented block. This stylish apartment offers well-proportioned accommodation throughout, including a fantastic kitchen/dining/living room with direct access to a large private terrace, two double bedrooms and a family bathroom. Further benefits include under floor heating, video entry and low energy lighting. There is also parking by separate negotiation.

Brondesbury Park is superbly situated moment from Brondesbury Park over ground with convenient access to many fashionable cafes and local amenities of Queens Park.

Available now on a part furnished or unfurnished basis

Viewings highly recommended!

- TWO BEDROOMS
- ONE BATHROOM
- OPEN PLAN LIVING
- LARGE BALCONY
- AVAILABLE NOW
- PART FURNISHED OR UNFURNISHED
- PARKING BY SEPERATE NEGOTIATION





**Embankment House,
Salsbury Road, NW6 7YE**

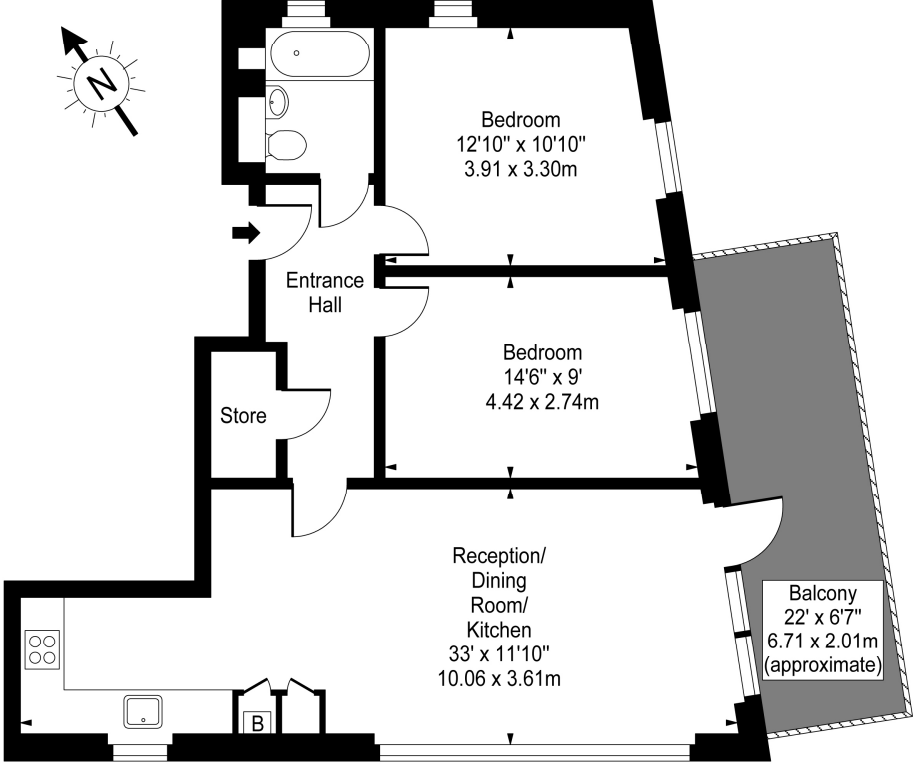

Fourth Floor

Approx Gross Internal Area **746 Sq Ft - 69.30 Sq M**

For Illustration Purposes Only - Not To Scale
www.goldlens.co.uk
 Ref. No. 010650K

Energy Efficiency Rating		
	Current	Potential
Very energy efficient - lower running costs		
(92+) A		
(81-91) B		
(69-80) C	82	82
(55-68) D		
(39-54) E		
(21-38) F		
(1-20) G		
Not energy efficient - higher running costs		
England, Scotland & Wales	EU Directive 2002/91/EC	

Agents Note: Whilst every care has been taken to prepare these sales particulars, they are for guidance purposes only. All measurements are approximate and for general guidance purposes only and whilst every care has been taken to ensure their accuracy, they should not be relied upon and potential buyers are advised to recheck the measurements